

Torque, Knob, Screw Assemblies, Pads

You Really Need These Fixture Items!

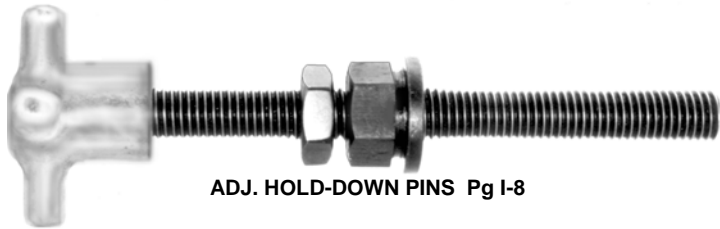

ADJ. HOLD-DOWN PINS Pg I-8



LARGE SWIVEL PAD SCREWS Pg I-2



ADJ. TORQUE SCREWS Pg I-13



SWIVEL KNOB SCREW BODIES Pg I-6

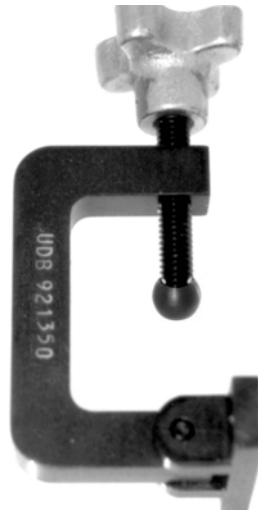

HINGE CLAMPS Pg I-10



KNURLED SHOULDER SCREWS Pg I-8



EXTRA LARGE PAD SWIVEL KNOB SCREWS Pg I-6



TORQUE HEAD SCREWS WITH TOGGLE PADS Pg I-12



AD. TORQUE HANDLES Pg I-13



ROUND PAD SWIVEL HEAD SCREWS Pg I-3

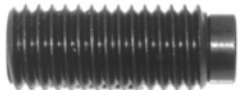

HEX HEADLESS SWIVEL SCREWS Pg I-14



JACK SCREWS Pg I-15

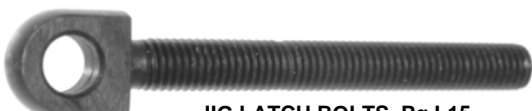

JIG LATCH BOLTS Pg I-15



QUARTER-TURN SCREWS Pg I-15



LARGE VEE PAD SWIVEL KNOB SCREWS Pg I-6

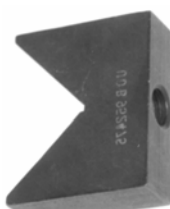

THE ORIGINAL KNURLED HEAD SCREWS Pg I-12

SWIVEL SCREW PADS Pg I-4

Swivel Screws with Removable Pads

Endless Clamping Options

Threaded Ball allows removal of Swivel pads.

Swivel Pads are interchangeable with each thread size. See page I-4.
ALLOY STEEL — CASE-HARDENED — BLACK OXIDE FINISH

SMALL PAD SWIVEL SCREW



ONE PAD INCLUDED IN ASSEMBLY

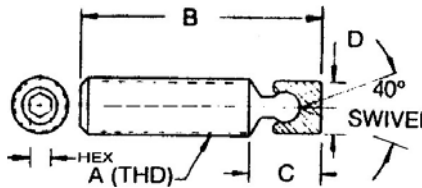

SWIVEL SCREW CLAMP WITH SMALL FOOT

PART NO.	A	B	C	D	HEX	PART NO.	A	B	C	D	HEX
UDB-952605	1/4-20	1/2	9/32	3/16	1/8	UDB-952616	3/8-16	2	3/8	19/64	3/16
UDB-952606	1/4-20	3/4	9/32	3/16	1/8	UDB-952639	3/8-16	3	3/8	19/64	3/16
UDB-952607	1/4-20	1	9/32	3/16	1/8	UDB-952617	1/2-13	1-1/2	15/32	13/32	1/4
UDB-952608	1/4-20	1-1/2	9/32	3/16	1/8	UDB-952618	1/2-13	2	15/32	13/32	1/4
UDB-952609	5/16-18	3/4	11/32	1/4	5/32	UDB-952619	1/2-13	3	15/32	13/32	1/4
UDB-952610	5/16-18	1	11/32	1/4	5/32	UDB-952640	1/2-13	4	15/32	13/32	1/4
UDB-952611	5/16-18	1-1/2	11/32	1/4	5/32	UDB-952620	5/8-11	2	5/8	1/2	5/16
UDB-952612	5/16-18	2	11/32	1/4	5/32	UDB-952621	5/8-11	3	5/8	1/2	5/16
UDB-952613	3/8-16	3/4	3/8	19/64	3/16	UDB-952641	5/8-11	4	5/8	1/2	5/16
UDB-952614	3/8-16	1	3/8	19/64	3/16	UDB-952642	5/8-11	5	5/8	1/2	5/16
UDB-952615	3/8-16	1-1/2	3/8	19/64	3/16						

Add 'N' to Part No. for NYLON PAD.

LARGE PAD SWIVEL SCREW

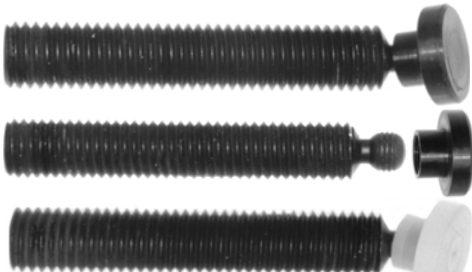

Add 'N' to Part No. for NYLON PAD.

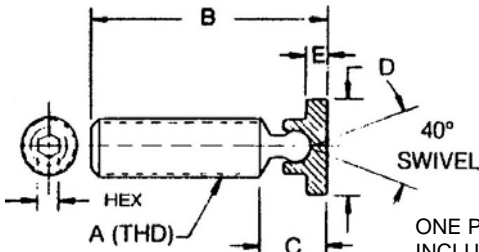

SWIVEL SCREW CLAMP WITH LARGE FOOT

ONE PAD INCLUDED IN ASSEMBLY

Removable Pads. Add 'N' to Part No. for NYLON PAD.

PART NO.	A	B	C	D	E	HEX
UDB-952622	1/4-20	19/32	23/64	3/8	1/8	1/8
UDB-952623	1/4-20	27/32	23/64	3/8	1/8	1/8
UDB-952624	1/4-20	1-3/32	23/64	3/8	1/8	1/8
UDB-952625	1/4-20	1-19/32	23/64	3/8	1/8	1/8
UDB-952626	5/16-18	27/32	27/64	1/2	5/32	5/32
UDB-952627	5/16-18	1-3/32	27/64	1/2	5/32	5/32
UDB-952628	5/16-18	1-19/32	27/64	1/2	5/32	5/32
UDB-952629	5/16-18	2-3/32	27/64	1/2	5/32	5/32
UDB-952630	3/8-16	7/8	1/2	9/16	3/16	3/16
UDB-952631	3/8-16	1-1/8	1/2	9/16	3/16	3/16
UDB-952632	3/8-16	1-5/8	1/2	9/16	3/16	3/16
UDB-952633	3/8-16	2-1/8	1/2	9/16	3/16	3/16
UDB-952643	3/8-16	3-1/8	1/2	9/16	3/16	3/16
UDB-952634	1/2-13	1-9/16	17/32	3/4	3/16	1/4
UDB-952635	1/2-13	2-1/16	17/32	3/4	3/16	1/4
UDB-952636	1/2-13	3-1/16	17/32	3/4	3/16	1/4
UDB-952644	1/2-13	4-1/16	17/32	3/4	3/16	1/4
UDB-952637	5/8-11	2-3/64	21/32	15/16	7/32	5/16
UDB-952638	5/8-11	3-3/64	21/32	15/16	7/32	5/16
UDB-952645	5/8-11	4-3/64	21/32	15/16	7/32	5/16
UDB-952646	5/8-11	5-3/64	21/32	15/16	7/32	5/16

ROUND PAD SWIVEL SCREW



Threaded Ball allows removal of Interchangeable Swivel pads, which are required.

ALLOY STEEL — CASE-HARDENED — BLACK OXIDE FINISH

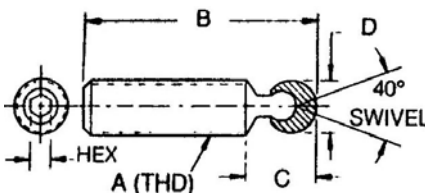

SWIVEL SCREW CLAMP WITH ROUND FOOT

ONE PAD INCLUDED IN ASSEMBLY

PART NO.	A	B	C	D	HEX	PART NO.	A	B	C	D	HEX
UDB-952647	1/4-20	17/32	5/16	1/4	1/8	UDB-952658	3/8-16	2-1/32	7/16	3/8	3/16
UDB-952648	1/4-20	25/32	5/16	1/4	1/8	UDB-952659	3/8-16	3-1/32	7/16	3/8	3/16
UDB-952649	1/4-20	1-1/32	5/16	1/4	1/8	UDB-952660	1/2-13	1-19/32	9/16	1/2	1/4
UDB-952650	1/4-20	1-17/32	5/16	1/4	1/8	UDB-952661	1/2-13	2-3/32	9/16	1/2	1/4
UDB-952651	5/16-18	25/32	23/64	5/16	5/32	UDB-952662	1/2-13	3-3/32	9/16	1/2	1/4
UDB-952652	5/16-18	1-1/32	23/64	5/16	5/32	UDB-952663	1/2-13	4-3/32	9/16	1/2	1/4
UDB-952653	5/16-18	1-17/32	23/64	5/16	5/32	UDB-952664	5/8-11	2-7/32	11/16	5/8	5/16
UDB-952654	5/16-18	2-1/32	23/64	5/16	5/32	UDB-952665	5/8-11	3-7/32	11/16	5/8	5/16
UDB-952655	3/8-16	25/32	7/16	3/8	3/16	UDB-952666	5/8-11	4-7/32	11/16	5/8	5/16
UDB-952656	3/8-16	1-1/32	7/16	3/8	3/16	UDB-952667	5/8-11	5-7/32	11/16	5/8	5/16
UDB-952657	3/8-16	1-17/32	7/16	3/8	3/16						

See Page I-4 for Pad selections.

Multi Clamping Options

Swivel Head Screws With Removable Pads

Swivel Head Screws Removable Pads

SMALL PAD SWIVEL HEAD

ALLOY STEEL – CASE-HARDENED
BLACK OXIDE FINISH

ASSEMBLY

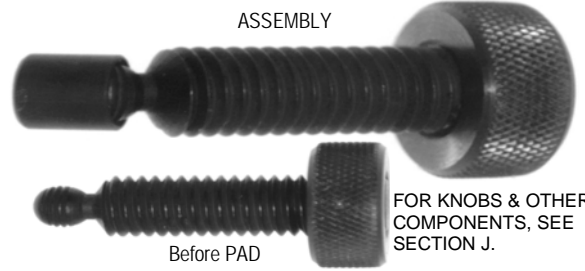

FOR KNOBS & OTHER
COMPONENTS, SEE
SECTION J.

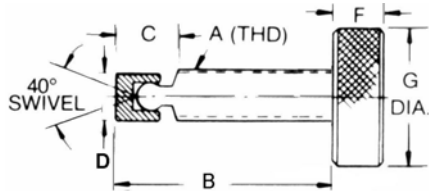

SWIVEL HEAD
SCREW WITH
SMALL FOOT
(INCLUDED)
Add 'N' to
Part No. for
Nylon Pad.

PART NO.	A	B	C	D	F	G
UDB-952505	1/4-20	1"	9/32	3/16	5/16	1"
UDB-952506	1/4-20	1-1/2	9/32	3/16	5/16	1"
UDB-952507	1/4-20	2"	9/32	3/16	5/16	1"
UDB-952531	1/4-20	3"	9/32	3/16	5/16	1"
UDB-952508	5/16-18	1"	11/32	1/4	3/8	1-1/8
UDB-952509	5/16-18	1-1/2	11/32	1/4	3/8	1-1/8
UDB-952510	5/16-18	2"	11/32	1/4	3/8	1-1/8
UDB-952532	5/16-18	3"	11/32	1/4	3/8	1-1/8
UDB-952511	3/8-16	1-1/2	3/8	19/64	7/16	1-1/4
UDB-952512	3/8-16	2"	3/8	19/64	7/16	1-1/4
UDB-952533	3/8-16	3"	3/8	19/64	7/16	1-1/4
UDB-952534	3/8-16	4"	3/8	19/64	7/16	1-1/4
UDB-952513	1/2-13	1-1/2	15/32	13/32	1/2	1-1/4
UDB-952514	1/2-13	2"	15/32	13/32	1/2	1-1/4
UDB-952515	1/2-13	3"	15/32	13/32	1/2	1-1/4
UDB-952535	1/2-13	4"	15/32	13/32	1/2	1-1/4
UDB-952516	5/8-11	2"	5/8	1/2	1/2	1-1/4
UDB-952517	5/8-11	3"	5/8	1/2	1/2	1-1/4
UDB-952536	5/8-11	4"	5/8	1/2	1/2	1-1/4
UDB-952537	5/8-11	5"	5/8	1/2	1/2	1-1/4

LARGE PAD SWIVEL HEAD SCREW

ASSEMBLY

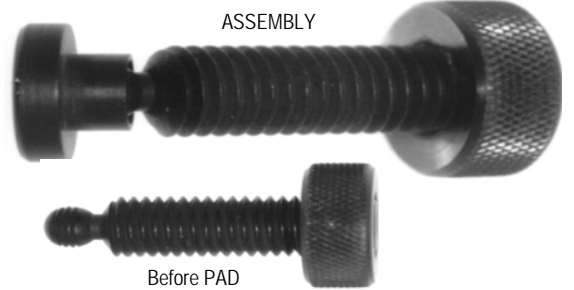

SWIVEL HEAD
SCREW WITH
LARGE FOOT
(INCLUDED)
Add 'N' to Part No.
for Nylon Pad.

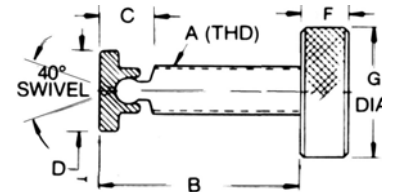

PART NO.	A	B	C	D	F	G
UDB-952518	1/4-20	1-3/32	23/64	3/8	5/16	1"
UDB-952519	1/4-20	1-19/32	23/64	3/8	5/16	1"
UDB-952520	1/4-20	2-3/32	23/64	3/8	5/16	1"
UDB-952538	1/4-20	3-3/32	23/64	3/8	5/16	1"
UDB-952521	5/16-18	1-3/32	27/64	1/2	3/8	1-1/8
UDB-952522	5/16-18	1-19/32	27/64	1/2	3/8	1-1/8
UDB-952523	5/16-18	2-3/32	27/64	1/2	3/8	1-1/8
UDB-952539	5/16-18	3-3/32	27/64	1/2	3/8	1-1/8
UDB-952524	3/8-16	1-5/8	1/2	9/16	7/16	1-1/4
UDB-952525	3/8-16	2-1/8	1/2	9/16	7/16	1-1/4
UDB-952540	3/8-16	3-1/8	1/2	9/16	7/16	1-1/4
UDB-952541	3/8-16	4-1/8	1/2	9/16	7/16	1-1/4
UDB-952526	1/2-13	1-9/16	17/32	3/4	1/2	1-1/4
UDB-952527	1/2-13	2-1/16	17/32	3/4	1/2	1-1/4
UDB-952528	1/2-13	3-1/16	17/32	3/4	1/2	1-1/4
UDB-952542	1/2-13	4-1/16	17/32	3/4	1/2	1-1/4
UDB-952529	5/8-11	2-3/64	21/32	15/16	1/2	1-1/4
UDB-952530	5/8-11	3-3/64	21/32	15/16	1/2	1-1/4
UDB-952543	5/8-11	4-3/64	21/32	15/16	1/2	1-1/4
UDB-952544	5/8-11	5-3/64	21/32	15/16	1/2	1-1/4

ROUND PAD SWIVEL HEAD SCREW

FOR KNOBS & OTHER COMPONENTS, SEE SECTION J.

ASSEMBLY

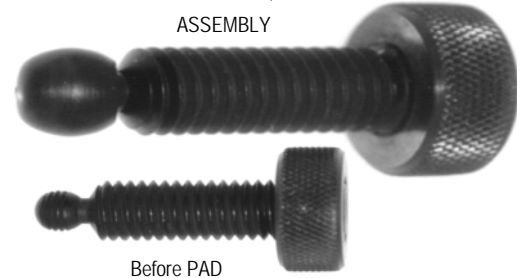

SWIVEL HEAD
SCREW WITH
ROUND FOOT
(INCLUDED)
Add 'N' to Part No.
for Nylon Pad.

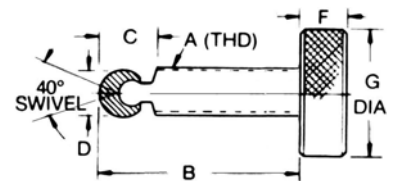

PART NO.	A	B	C	D	F	G
UDB-952545	1/4-20	1-1/32	5/16	1/4	5/16	1"
UDB-952546	1/4-20	1-17/32	5/16	1/4	5/16	1"
UDB-952547	1/4-20	2-1/32	5/16	1/4	5/16	1"
UDB-952548	1/4-20	3-3/32	5/16	1/4	5/16	1"
UDB-952549	5/16-18	1-1/64	23/64	5/16	3/8	1-1/8
UDB-952550	5/16-18	1-33/64	23/64	5/16	3/8	1-1/8
UDB-952551	5/16-18	2-1/64	23/64	5/16	3/8	1-1/8
UDB-952552	5/16-18	3-1/64	23/64	5/16	3/8	1-1/8
UDB-952553	3/8-16	1-9/16	7/16	19/64	7/16	1-1/4
UDB-952554	3/8-16	2-1/16	7/16	19/64	7/16	1-1/4
UDB-952555	3/8-16	3-1/16	7/16	19/64	7/16	1-1/4
UDB-952556	3/8-16	4-1/16	7/16	19/64	7/16	1-1/4
UDB-952557	1/2-13	1-19/32	9/16	13/32	1/2	1-1/4
UDB-952558	1/2-13	2-3/32	9/16	13/32	1/2	1-1/4
UDB-952559	1/2-13	3-3/32	9/16	13/32	1/2	1-1/4
UDB-952560	1/2-13	4-3/32	9/16	13/32	1/2	1-1/4
UDB-952561	5/8-11	2-1/8	11/16	5/8	1/2	1-1/4
UDB-952562	5/8-11	3-1/8	11/16	5/8	1/2	1-1/4
UDB-952563	5/8-11	4-1/8	11/16	5/8	1/2	1-1/4
UDB-952564	5/8-11	5-1/8	11/16	5/8	1/2	1-1/4

Swivel Screw Bodies and Pads

Do It Yourself With Our Swivel Screws and

SWIVEL SCREW BODIES

ALLOY STEEL CASE - HARDENED BLACK OXIDE FINISH
 THREADED END ALLOWS FAST INSTALLATION OF PAD REQUIRED
 FOR KNOBS & OTHER COMPONENTS, SEE SECTION J.

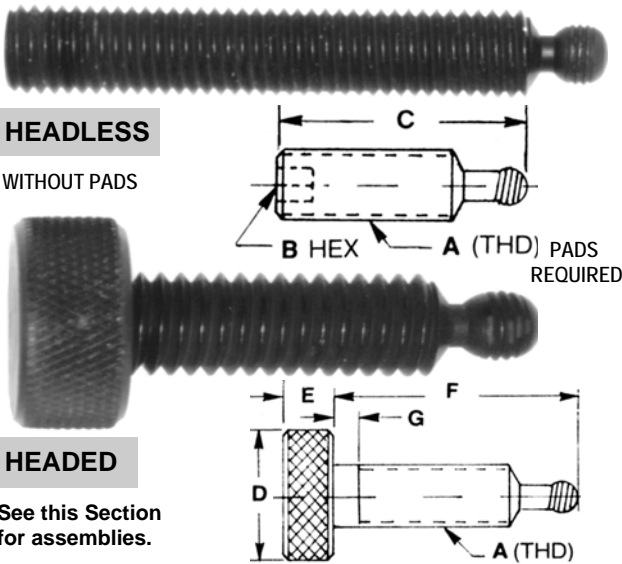

HEADLESS TYPE SCREW BODIES				HEADED TYPE SCREW BODIES					
PART NO.	A-BODY	B	C	PART NO.	A-BODY	D	E	F	G
UDB-952301			15/32	UDB-952343				31/32	
UDB-952303	1/4-20	1/8	23/32	UDB-952345	1/4-20	1"	5/16	1-15/32	1/8
UDB-952305	BALL THD is 8-36-LH		31/32	UDB-952347	BALL THD is 8-36-LH			1-31/32	
UDB-952307			1-15/32	UDB-952349				2-31/32	
UDB-952309			23/32	UDB-952351				31/32	
UDB-952311	5/16-18	5/32	31/32	UDB-952353	5/16-18	1-1/8	3/8	1-15/32	3/16
UDB-952313	BALL THD is 12-28-LH		1-15/32	UDB-952355	BALL THD is 12-28-LH			1-31/32	
UDB-952315			1-31/32	UDB-952357				2-31/32	
UDB-952317			11/16	UDB-952359				1-7/16	
UDB-952319			15/16	UDB-952361	3/8-16	1-1/4	7/16	1-15/16	3/16
UDB-952321	3/8-16	3/16	1-7/16	UDB-952363	BALL THD is 1/4-28-LH			2-15/16	
UDB-952323	BALL THD is 1/4-28-LH		1-15/16	UDB-952365				3-15/16	
UDB-952325			2-15/16	UDB-952367				1-7/16	
UDB-952327			1-7/16	UDB-952369	1/2-13	1-1/4	1/2	1-15/16	3/16
UDB-952329	1/2-13	1/4	1-15/16	UDB-952371	BALL THD is 5/16-24-LH			2-15/16	
UDB-952331	BALL THD is 5/16-24-LH		2-15/16	UDB-952373				3-15/16	
UDB-952333			3-15/16	UDB-952375				1-15/16	
UDB-952335			1-15/16	UDB-952377	5/8-11	1-1/4	1/2	2-15/16	3/16
UDB-952337	5/8-11	5/16	2-15/16	UDB-952379	BALL THD is 7/16-20-LH			3-15/16	
UDB-952339	BALL THD is 7/16-20-LH		3-15/16	UDB-952381				4-15/16	
UDB-952341			4-15/16						

SWIVEL SCREW PADS ONLY

ALLOY STEEL CASE-HARDENED BLACK OXIDE FINISH
 TYPE II CLASS 3 - LEFT HAND THREAD PREVENTS BACKOUT

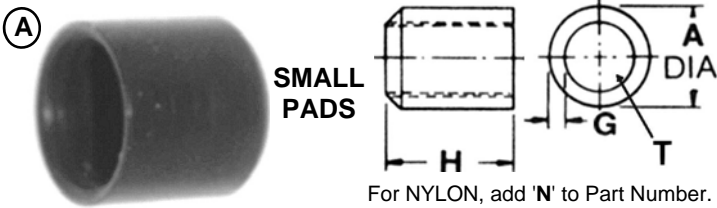

SMALL PADS	A	G	H	T	INTERNAL THD	FITS BODY THD
UDB-952403	.146	.026	.125		4-48 LH	10-32
UDB-952405	.187	.031	.200		8-36 LH	1/4-20
UDB-952410	.250	.046	.255		12-28 LH	5/16-18
UDB-952415	.298	.053	.315		1/4-28 LH	3/8-16
UDB-952420	.406	.058	.359		5/16-24 LH	1/2-13
UDB-952425	.500	.076	.470		7/16-20 LH	5/8-11
UDB-952428	.625	.093	.470		7/16-20 LH	3/4-10

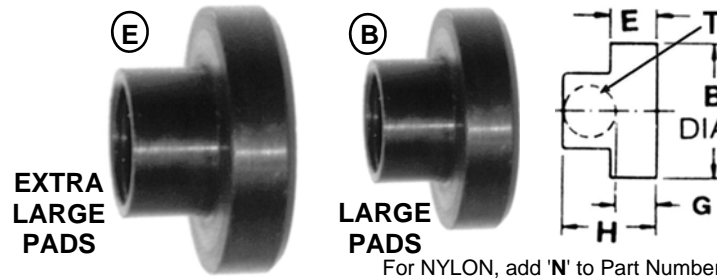

LARGE PADS	B	E	G	H	T	INTERNAL THD	FITS BODY THD
UDB-952430	.375	.125	.131	.300		8-36 LH	1/4-20
UDB-952435	.500	.156	.141	.350		12-28 LH	5/16-18
UDB-952440	.562	.187	.177	.437		1/4-28 LH	3/8-16
UDB-952445	.750	.187	.119	.420		5/16-24 LH	1/2-13
UDB-952450	.930	.218	.121	.515		7/16-20 LH	5/8-11
EXTRA LARGE	B	E	G	H	T	INTERNAL THD	FITS BODY THD
UDB-952452	1.50	1/4	.26	.50		5/16-24 LH	1/2-13
UDB-952453	2.00	5/16	.31	.70		7/16-20 LH	5/8-18

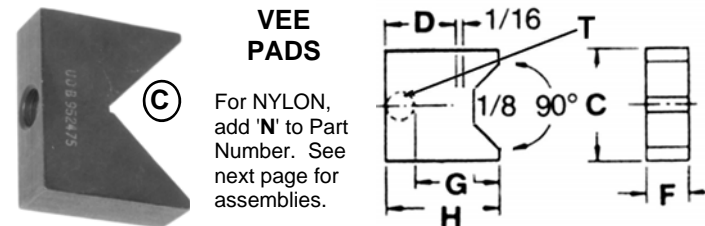

VEE PADS	C	D	F	G	H	T	I.D. INTERNAL THD	FITS BODY THD SIZE
UDB-952455	1.0	.500	.312	.706	.875		8-36 LH	1/4-20
UDB-952460	1.0	.562	.375	.729	.938		12-28 LH	5/16-18
UDB-952465	1.0	.625	.438	.739	1.000		1/4-28 LH	3/8-16
UDB-952470	2.0	.688	.500	1.199	1.500		5/16-24 LH	1/2-13
UDB-952475	2.0	.750	.625	1.231	1.725		7/16-20 LH	5/8-11

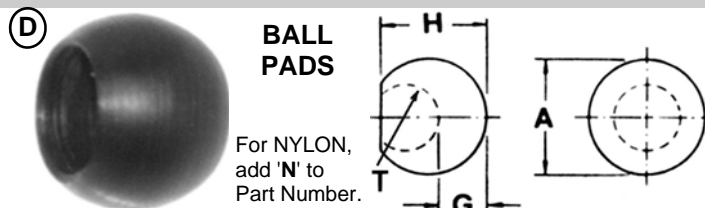

ROUND PADS	A	G	H	T	I.D. INTERNAL THD	FITS BODY THD SIZE
UDB-952480	.2500	.080	.220		8-36 LH	1/4-20
UDB-952485	.3125	.114	.280		12-28 LH	5/16-18
UDB-952490	.3750	.090	.325		1/4-28 LH	3/8-16
UDB-952495	.5000	.168	.433		5/16-24 LH	1/2-13
UDB-952500	.6250	.173	.531		7/16-20 LH	5/8-11

Hand Knob Swivel Screw Assy with Removable Pads



BODY — ALLOY STEEL — HARDENED — BLACK OXIDE FINISH
KNOBS — CAST IRON — ZINC PLATED — CLEAR CHROMATE FINISH

SMALL PAD SWIVEL KNOB SCREW

PART NO.	A	B	C	D	F	G
UDB-952565	1/4-20	1"	9/32	3/16	5/8	1-1/8
UDB-952566	1/4-20	1-1/2	9/32	3/16	5/8	1-1/8
UDB-952567	1/4-20	2"	9/32	3/16	5/8	1-1/8
UDB-952568	1/4-20	3"	9/32	3/16	5/8	1-1/8
UDB-952569	5/16-18	1"	11/32	1/4	7/8	1-1/2
UDB-952570	5/16-18	1-1/2	11/32	1/4	7/8	1-1/2
UDB-952571	5/16-18	2"	11/32	1/4	7/8	1-1/2
UDB-952572	5/16-18	3"	11/32	1/4	7/8	1-1/2
UDB-952573	3/8-16	1-1/2	3/8	19/64	1-1/8	2"
UDB-952574	3/8-16	2"	3/8	19/64	1-1/8	2"
UDB-952575	3/8-16	3"	3/8	19/64	1-1/8	2"
UDB-952576	3/8-16	4"	3/8	19/64	1-1/8	2"
UDB-952577	1/2-13	1-1/2	15/32	13/32	1-1/2	2"
UDB-952578	1/2-13	2"	15/32	13/32	1-1/2	2"
UDB-952579	1/2-13	3"	15/32	13/32	1-1/2	2"
UDB-952580	1/2-13	4"	15/32	13/32	1-1/2	2"
UDB-952581	5/8-11	2"	5/8	1/2	1-3/4	2-1/2
UDB-952582	5/8-11	3"	5/8	1/2	1-3/4	2-1/2
UDB-952583	5/8-11	4"	5/8	1/2	1-3/4	2-1/2
UDB-952584	5/8-11	5"	5/8	1/2	1-3/4	2-1/2

SWIVEL KNOB
SCREW WITH
SMALL FOOT

ASSEMBLY

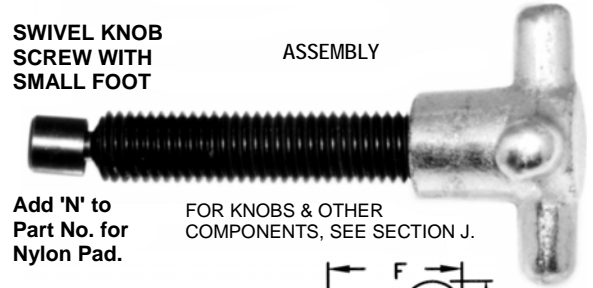

Add 'N' to
Part No. for
Nylon Pad.

FOR KNOBS & OTHER
COMPONENTS, SEE SECTION J.

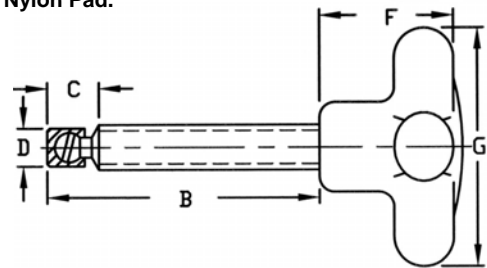

PART NO.	A	B	C	D	F	G
UDB-952585	1/4-20	1-3/32	23/64	3/8	5/8	1-1/8
UDB-952586	1/4-20	1-19/32	23/64	3/8	5/8	1-1/8
UDB-952587	1/4-20	2-3/32	23/64	3/8	5/8	1-1/8
UDB-952588	1/4-20	3-3/32	23/64	3/8	5/8	1-1/8
UDB-952589	5/16-18	1-3/32	27/64	1/2	7/8	1-1/2
UDB-952590	5/16-18	1-19/32	27/64	1/2	7/8	1-1/2
UDB-952591	5/16-18	2-3/32	27/64	1/2	7/8	1-1/2
UDB-952592	5/16-18	3-3/32	27/64	1/2	7/8	1-1/2
UDB-952593	3/8-16	1-5/8	1/2	9/16	1-1/8	2"
UDB-952594	3/8-16	2-1/8	1/2	9/16	1-1/8	2"
UDB-952595	3/8-16	3-1/8	1/2	9/16	1-1/8	2"
UDB-952596	3/8-16	4-1/8	1/2	9/16	1-1/8	2"
UDB-952597	1/2-13	1-9/16	17/32	3/4	1-1/2	2"
UDB-952598	1/2-13	2-1/16	17/32	3/4	1-1/2	2"
UDB-952599	1/2-13	3-1/16	17/32	3/4	1-1/2	2"
UDB-952600	1/2-13	4-1/16	17/32	3/4	1-1/2	2"
UDB-952601	5/8-11	2-3/64	21/32	15/16	1-3/4	2-1/2
UDB-952602	5/8-11	3-3/64	21/32	15/16	1-3/4	2-1/2
UDB-952603	5/8-11	4-3/64	21/32	15/16	1-3/4	2-1/2
UDB-952604	5/8-11	5-3/64	21/32	15/16	1-3/4	2-1/2

LARGE PAD SWIVEL KNOB SCREW

SWIVEL KNOB
SCREW WITH
LARGE FOOT

ASSEMBLY

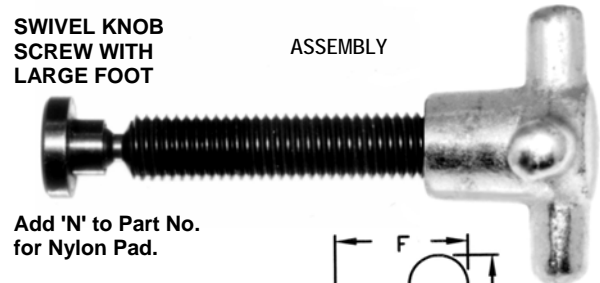

Add 'N' to Part No.
for Nylon Pad.

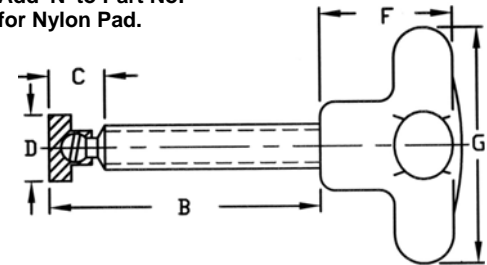

PART NO.	A	B	C	D	F	G
UDB-952675	1/4-20	1-1/32	5/16	1/4	5/8	1-1/8
UDB-952676	1/4-20	1-17/32	5/16	1/4	5/8	1-1/8
UDB-952677	1/4-20	2-1/32	5/16	1/4	5/8	1-1/8
UDB-952678	1/4-20	3-3/32	5/16	1/4	5/8	1-1/8
UDB-952679	5/16-18	1-1/64	23/64	5/16	7/8	1-1/2
UDB-952680	5/16-18	1-33/64	23/64	5/16	7/8	1-1/2
UDB-952681	5/16-18	2-1/64	23/64	5/16	7/8	1-1/2
UDB-952682	5/16-18	3-1/64	23/64	5/16	7/8	1-1/2
UDB-952683	3/8-16	1-9/16	7/16	19/64	1-1/8	2"
UDB-952684	3/8-16	2-1/16	7/16	19/64	1-1/8	2"
UDB-952685	3/8-16	3-1/16	7/16	19/64	1-1/8	2"
UDB-952686	3/8-16	4-1/16	7/16	19/64	1-1/8	2"
UDB-952687	1/2-13	1-19/32	9/16	13/32	1-1/2	2"
UDB-952688	1/2-13	2-3/32	9/16	13/32	1-1/2	2"
UDB-952689	1/2-13	3-3/32	9/16	13/32	1-1/2	2"
UDB-952690	1/2-13	4-3/32	9/16	13/32	1-1/2	2"
UDB-952691	5/8-11	2-1/8	11/16	5/8	1-3/4	2-1/2
UDB-952692	5/8-11	3-1/8	11/16	5/8	1-3/4	2-1/2
UDB-952693	5/8-11	4-1/8	11/16	5/8	1-3/4	2-1/2
UDB-952694	5/8-11	5-1/8	11/16	5/8	1-3/4	2-1/2

ROUND PAD SWIVEL KNOB

SWIVEL KNOB
SCREW WITH
ROUND FOOT

ASSEMBLY

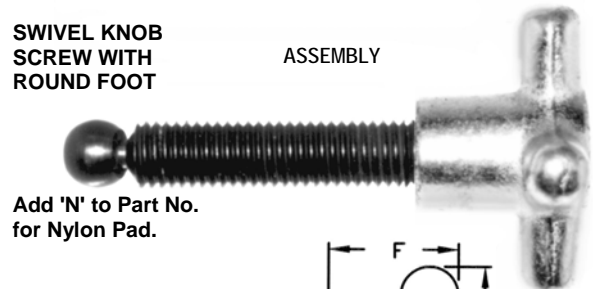

Add 'N' to Part No.
for Nylon Pad.

